

MS FLEX PLUS

MS FLEX Plus is a minor surgery and advanced exploration luminaire. The lamp is manufactured with a LED light source and it is mounted with a highly precise flexible arm. Its arm allows the luminaire to be adjusted in any position.

The quality of the materials used in its manufacture makes it especially suitable for intensive use in surgery and examinations.

Exceptional quality of LED light

The powerful LED light source offers exceptional light quality and a lifespan of more than 50,000 hours.

The high performance of the color Ra 97% depicts the exceptional quality of white light for an excellent distinction of fabrics and its reproducing all visible colors, naturally and precisely.

Ergonomic design

The circular shape of the head and its handle in the lower part facilitate its exact positioning, fulfilling the ergonomic requirements for any use.

Designed with clean and soft shapes which facilitate hygiene and cleanliness in medical environments.

Mounting options

The standard version includes AH table clamp.

As for accessories, we offer a wide selection of supports such as wall supports, wall extension arms, trolleys stand and rail brackets.

MS FLEX PLUS

Technical Details	(REF. M187001FL)
Light source	LED 12W
Illumination at 50 cm	65.000 lux
Dimmable	Yes
Color temperature	4.500 °K
Color rendering	> 97%
Useful life	50.000 hours
Flexible Arm Length	700 mm
Color	White

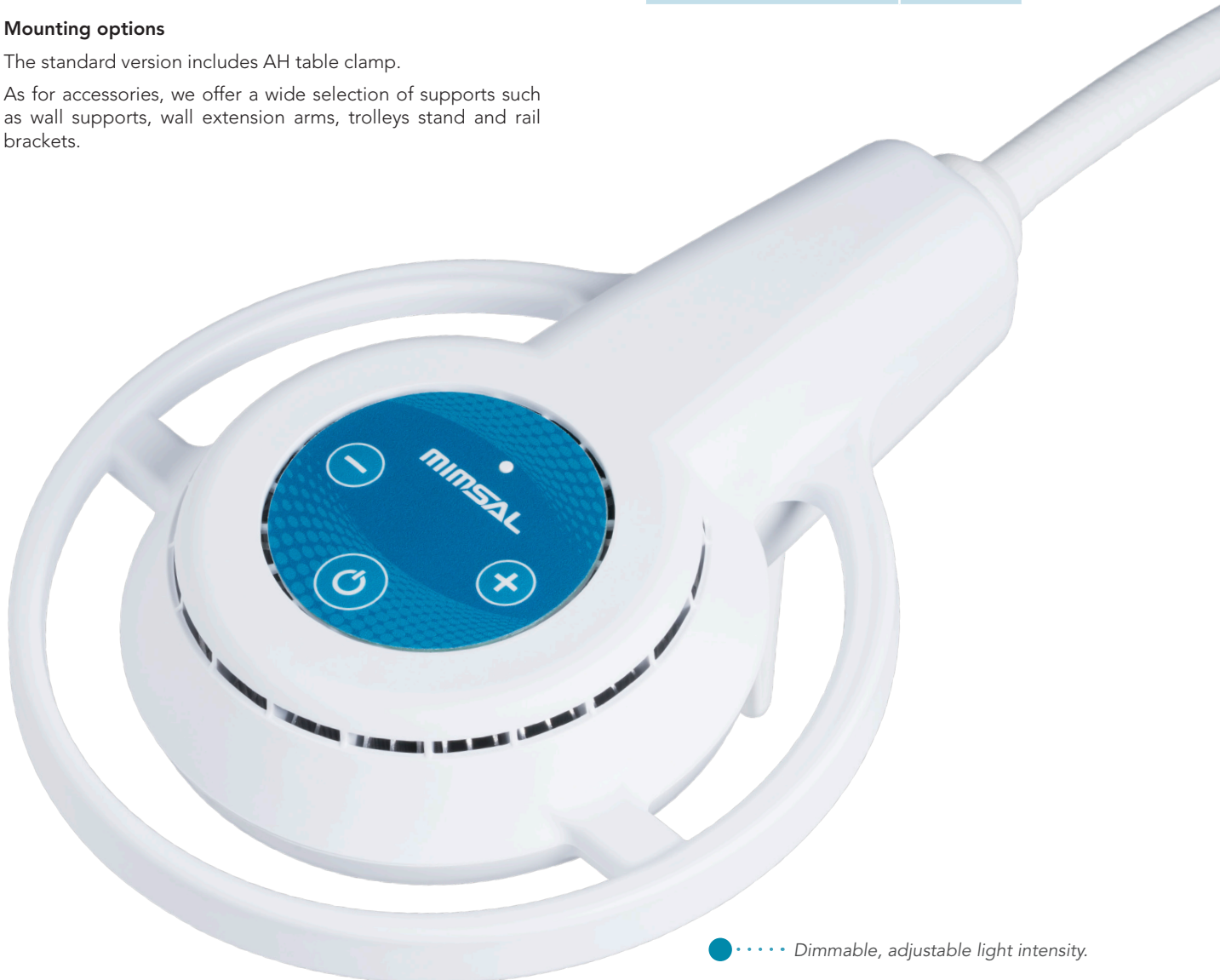

●..... Dimmable, adjustable light intensity.

Medguard Professional Healthcare

Tel: 01 835 2378

Email: orders@medguard.ie

Fax: 01 969 5009

Web: www.medguard.ie

Unit 6/7, Block 4, Ashbourne Business Park, Ashbourne, Co. Meath, Ireland



WALL B SUPPORT
REF. B0101800



AH TABLE CLAMP
REF. B010190



RAIL PLUS BRACKET
REF. 82026



EXTENSION ARM
REF. B0101S0

TROLLEY STAND
8,8 kg REF. 09651

