

MYNEB

PORTABLE
AEROSOL THERAPY DEVICE
WITH PISTON
MICRO-COMPRESSOR



CE 0434
(dir. 93/42/EEC)



COMPONENTS

- a. Compressor housing
- b. O/I switch
- c. Batteries and air filter housing
- d. Air filter lid
- e. Air outlet
- f. 12Vdc jack
- g. Indication led
- h. Integrated battery charge

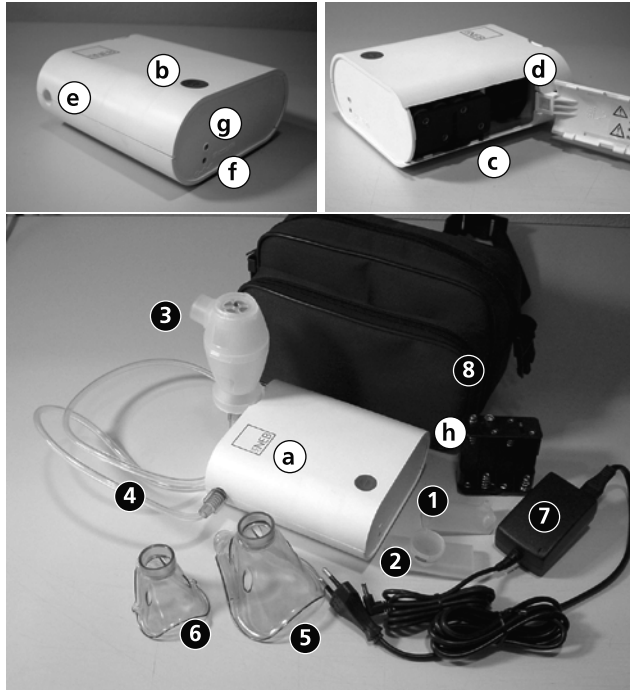

STANDARD ACCESSORIES

1. Nasal prong
2. Mouthpiece
3. Fasterjet nebulizer
4. Air connection tube
5. Adult mask
6. Child mask
7. 12Vdc universal power adapter with power cable
8. Carrying bag
9. Car cigarette lighter plug



WARNING

MYNEB is an medical device (in compliance with MDD 93/42/EEC) for the treatment and relieve of respiratory ailments. Good for domestic use, but thanks to its versatility it can be use always and everywhere (but always to repair by atmospherics agents).

MYNEB is equipped with a powerful piston compressor that does not need lubrication. The unit includes an air filter to be periodically replaced (every 70 applications). It is built in compliance with the current European Manufacturing and Safety Standards for electromedical equipments (EN 60601-1; EN13544-1).

MYNEB is supplied with the following 3A accessories: Fasterjet nebulizer bulb with mouthpiece, nasal prong, child mask, adult mask, air connection tube, air filter; 12Vdc universal power adapter with power cable; carrying bag; car cigarette lighter plug; integrated battery charge.

IMPORTANT SAFEGUARD

This is a medical device and to be used only upon medical prescription and to be operated in accordance with this manual. It is important that the patient reads and understands the information provided for use of the unit. Please contact your retailer with any question. Children and invalids should always use the unit under strict supervision of an adult who had read this manual.

Use the unit as described in this manual, i.e. as an aerosol therapy system, following the instructions of your physi-

cian. Use for any purpose other than that for which the unit is designed is to be considered improper and dangerous; the manufacturer cannot be held liable for damage caused by improper, incorrect and/or unreasonable use or if the unit is connected to an electrical system that does not comply with current safety standards.

Please retain this manual for future reference.

CAUTION

Unit case not water – proof.

The unit should not be used in the presence of anesthetic mixture inflammable with air, oxygen or nitrous oxide or with any substances and/or gas can be dangerous

In compliance with EMC standard (EN60601-1-2)

We advise against using extension cords or adapters (should their use be unavoidable, utilise only types conforming to current safety standards. Make sure not to exceed the maximum power limits indicated on adapters and extension cords), and always remember to unwind the power supply cord to prevent dangerous overheating. Keep the power adapter, the cord and unit away from hot surfaces and from direct heat sources.

Before plugging in the unit, make sure that the electrical data shown on the rating plate on the bottom of the unit match the specifications of the mains power supply.

If the plug provided with the unit is not compatible with the mains power socket, it must be replaced with a suitable plug. This job may be performed by qualified personnel only.

Use only original accessories and components(cords, adapter, nebulizer kit etc); Use only battery indicated in this manual.

Never immerse the unit and the power adapter in water; should this accidentally occur, immediately pull out the plug. Do not remove or touch the unit under water before pulling out the plug. Do not reuse the unit after taking it out of the water (send it immediately to an authorised service centre).

Do not handle the unit with wet hands;

Protect the unit from exposure to atmospheric agents;

During use with power adapter, place the unit on a stable, horizontal surface;

Children and disabled persons may only use the unit under the careful supervision of an adult in full possession of his/her faculties;

Do not yank on the power supply cord or the unit itself to remove the plug from the power socket.

Do not leave the unit plugged in unnecessarily: unplug the unit when it is not in use. In case you don't use the unit for long time, take out the battery.

Remember to:

- use this unit only with medication prescribed by your physician;
- perform the treatment using only the accessory indicated

by your physician, according to the complaint to be treated;

- medications in suspension or with a high viscosity should be administered according to the instructions provided with the same by the medication producer.

In case of unit failure and/or malfunctioning consult the "Troubleshooting" section. Do not tamper with or attempt to open the compressor housing.

In the event that the cord or the power adapter is damaged, contact a qualified technical service centre to have it replaced.

Service should be performed only by authorized staff, repair not authorized avoids the warranty and can compromise the safety.

MICROBIC CONTAMINATION

In the presence of pathologies with the risk of infection and microbic contamination, a personal

use of the accessories and the nebulizing bulb is suggested (always consult your physician).

USER INSTRUCTION



When the appliance is operating normally, (either with the external power supply unit or with the internal battery), no pilot light comes on. In the event of an operating problem or a mistake in inserting the batteries, or if insufficiently charged batteries are used, the appliance has a luminous LED with various colours, positioned on the right hand side of the appliance close to the power supply connector, to indicate the nature of the problem. In order to interpret the luminous indications given by the appliance, see table 1.

OPERATION WITH THE UNIVERSAL POWER SUPPLY UNIT – MAINS CURRENT

CAUTION: Use only the power supply unit supplied with this medical device (Switching Power Adapter 12V-1.67A MODEL UE20-120167SPA1) or its spare part as indicated by manufacturer (code 3A1494). Use only the power cord supplied with this medical device or its spare part as indicated by manufacturer (Code 3A1493) The use of others power supply units or/and cables can be very dangerous for your and product safety

Prepare the FASTERJET nebuliser as indicated in the instruction manual and position the appliance on a flat, stable and clean surface. Connect the power supply unit to the appliance using the special connector and insert the power supply plug of the power supply unit into the main socket (Fig. 1). Connect the nebuliser to the appliance using the tube supplied and then press the “on” button to start treatment. To suspend or terminate treatment, press the “on” button again.

With the batteries inserted, the appliance is anyway supplied with power from the transformer by pressing the “on” switch.

OPERATION WITH A CIGARETTE LIGHTER CABLE – 12V

CAUTION: Use only the cigarettes lighter cable supplied with this medical device or its spare part as indicated by manufacturer (code 3A1492). The use of others cigarettes lighter cable can be very dangerous for your and product safety

Prepare the FASTERJET nebuliser as indicated in the instruction manual. Position the appliance and connect the cigarette lighter cable to the appliance using the connector supplied and insert the power supply plug into the 12V connector (Fig. 8). Connect the nebuliser to the appliance using the tube supplied and then press the “on” button to start treatment. To suspend or terminate treatment, press the “on” button again.

With the batteries inserted, the appliance is anyway supplied with power from the cigarette lighter cable by pressing the “on” switch.

OPERATION WITH POWER SUPPLY FROM RECHARGEABLE BATTERIES

Caution: Do not put in or change batteries with power adapter/car plug connected to the unit

Position the appliance on a flat surface with sufficient space for performing the operation. To access the battery compartment, open the rear hatch (Fig. 2a,2b,2c) by sliding it laterally up to the release position, applying sufficient pressure. Remove the battery container contained inside and refrain from pulling excessively on the connection cables attached to the same.

Extracting the battery container brusquely or pulling the power supply wires too hard may damage the appliance.

Insert the purchased batteries (Fig. 3 – 4), one by one, into the battery container paying extreme attention to:

- Inserting the batteries with their positive and negative poles correctly orientated (positive pole indicated on the battery used with the positive pole indicated on the battery container supplied).

- Only insert rechargeable Ni-MH batteries, type AA – 1.2 V with a capacity between 1500 and 2500 mAh.

- Never inserting used batteries the source of which you are unaware of, or ones lacking identification. Always make sure that the batteries used are of the kind indicated in this manual.

- The set of 8 batteries inserted into the appliance occasionally, must all have the SAME values and characteristics;

NEVER MIX BATTERIES WITH DIFFERENT CAPACITIES TOGETHER (for example, 4 batteries rated at 1500 mAh with 4 of 2500 mAh). Any such operations can seriously damage the batteries during operation or during the recharging cycle.

USER INSTRUCTION

Now, reinsert the battery container into the appliance (Fig. 5), taking care during the same to keep the cable connector to the right side of the compartment, otherwise the hatch may not re-close; if this occurs, remove the battery container and rotate it through 180°.

Now close the hatch again, as indicated in Figures 6 and 7. Prepare the FASTERJET nebuliser as indicated in the instruction manual and connect it to the appliance using the tube supplied; next, press the "on" button to start treatment.

- The exhausted battery should be disposed in accordance with current regulation.

⚠ CHARGING RECHARGEABLE BATTERIES
ATTENTION: ALWAYS CHECK FOR THE PRESENCE OF ALKALINE BATTERIES INSIDE THE APPLIANCE BEFORE PROCEEDING WITH THE RECHARGING CYCLE. NEVER CHARGE ALKALINE BATTERIES.

If not already inside, insert rechargeable Ni-MH batteries into the appliance; now connect this latter to the external power supply unit supplied (transformer or cigarette lighter cable) connected to the mains socket.

Now hold down the "on" switch for at least 3 seconds to start the charging cycle. Fast blinking of the green light indicates the effective start of the charging cycle.

Attention: It is not possible to switch on the appliance during charging. If the "on" switch is pressed, the compressor starts, but battery charging is interrupted.

During preparation and charging operations, the luminous indications of table II are foreseen.

CHARGING TIME AND BATTERY AUTONOMY INDICATIONS

Only use rechargeable Ni-MH batteries – type AA – 1.2 V with a capacity between 1500 mAh and 2500 mAh.

The constructor cannot be held responsible for problems caused by batteries with different capacities.

Indicative charging time for batteries with a capacity of 1500 mAh: max 4 hours

Indicative autonomy for batteries with a capacity of 1500 mAh: 40 minutes approx.

Indicative charging time for batteries with a capacity of 2500 mAh: max 6 hours

Indicative autonomy for batteries with a capacity of 2500 mAh: 90 minutes approx.

CAUTION:

- Avoid storing flat batteries as their autonomy could be reduced or definitively compromised.
- Even if not used, always recharge batteries every 3 months to prevent them from becoming damaged.
- Always store batteries in dry, cool places.
- The exhausted battery should be disposed in accordance with current regulation.

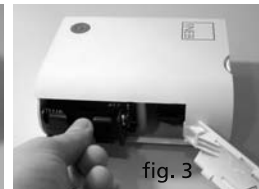
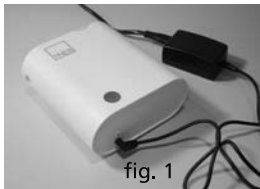

USER INSTRUCTION

OPERATION WITH ALKALINE BATTERY POWER SUPPLY

Only in the case of strict necessity may Alkaline batteries be used – type AA – 1.5 V.

Nevertheless, it is absolutely necessary to pay extreme attention to NEVER STARTING THE CHARGING CYCLE when these are inserted.

NEVER MIX ALKALINE BATTERIES WITH RECHARGEABLE ONES IN THE BATTERY CONTAINER. NEVER CHARGE ALKALINE BATTERIES.

We recommend removing alkaline batteries at the end of treatment to prevent accidental recharging of the same. Recharging alkaline batteries generates a dangerous overheating situation and possible deflagration. Neither the constructor or the distributor can be held responsible for failure to respect the precaution above.

Indicative autonomy of alkaline batteries type AA – 1.5 V: 30 minutes approx.

CAUTION: The exhausted battery should be disposed in accordance with current regulation.

SPARE PART LIST

CAUTION: Please to use only following original spare part; the use of component not recommended by manufacturer can be very dangerous. The 3A manufacturer is not responsible of damages caused by use of not original 3A spare parts

12Vdc universal power adapter (w/o power cable) (MODEL: UE20-120167SPA1)	code 3A1494
power cable for power adapter (european plug)	code 3A1493
Car cigarette lighter plug (with 3A fuse)	code 3A1492
Integrated battery charge (battery holder)	code 3A1487
Air filter (2 pcs)	code 3AC270
Fasterjet nebulizer kit (full optional)	code NEB100
Carrying bag	code 3A1497

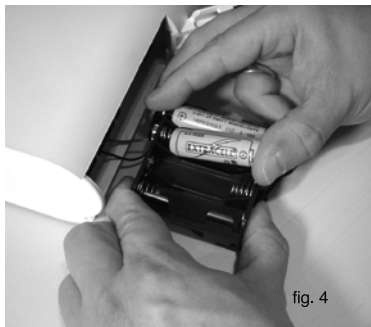

fig. 4

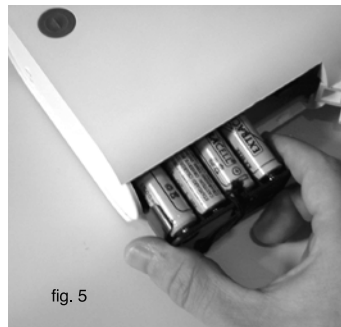

fig. 5



fig. 6

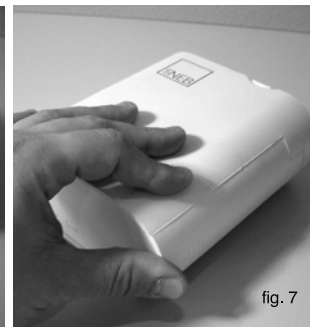

fig. 7

Figures 6 – 7 (hatch closing images)

TAB. 1 - LUMINOUS INDICATIONS DURING OPERATION

Led indication	Status	Problem/Cause	
Flashing red Led	Appliance in use with rechargeable battery	Flat battery	Start the charging cycle (only for rechargeable battery)
Flashing red Led	Appliance in use with alkaline battery	No problem (with alkaline battery the red led start to flash within first operating 4 minutes)	Use the unit until alkaline battery exhaustion, then replace the batteries.
Red Led permanently on	Appliance in blocked status	High motor temperature	Wait until the appliance cools (the red Led goes out) before start again
Red Led permanently on	Appliance in blocked status	Overload Short-circuit	Contact technical assistance
No Led on	Appliance in blocked status	Defective power supply unit or internal technical problem	Contact technical assistance
No Led on	Appliance in blocked status	Polarity inversion	Disconnect the power supply connector, check that the batteries are correctly inserted; now, re-connect the connector and re-start the appliance. If the problem returns, contact technical assistance.

TAB. II - LUMINOUS INDICATIONS DURING BATTERY CHARGING

Led indication	Phase	Problem/Cause	
Green Led flashing slowly	Device switched off and connected to the external power supply	No problem, the appliance is indicating that it is connected to the mains and in waiting mode	Start the charging cycle if necessary or disconnect the power supply if not necessary
Flashing green Led	During charging	Battery charging in progress	Wait
Green and red Led flashing alternately	During charging	a) Very flat batteries; charging cycle slow; reactivation in progress b) Battery or electrical circuit malfunctions	a) Wait for the normal charging cycle to start (max 24 hours) or replace the batteries. b) Disconnect the power supply unit connector, check that the batteries are inserted correctly and then re-connect the power supply unit connector. Now, restart the charging cycle. In the event of problems, contact technical assistance.
Green Led permanently on	During charging	Charging cycle completed	Disconnect the power supply unit
No Led on	At the charging cycle start	Defective power supply unit or internal technical problem	Contact technical assistance
No Led on	During charging	Appliance protection device intervention	Disconnect the power supply unit connector and re-connect it. Now, begin a new charging cycle. If the problem returns, contact technical assistance.

CLEANING AND DISINFECTION

When the application has finished, turn the unit off and carefully clean the accessories as indicated in additional sheet.

Do not wash the unit under running water or do not submerge it in water; wipe it only with a damp cloth using mild detergents. Do not use abrasive cleaners.

 **WARNING - When cleaning the unit, make sure that its internal components do not come into contact with liquids.**

FILTER REPLACEMENT

To replace the filter, carry out the following steps: gently pry open the battery compartment (fig. 2a, 2b, 2c), open the lid housing (fig. 8), remove the used filter and insert the replacement.

Lastly, fit the lid housing the filter back in place, making sure it closely adheres to the surface.

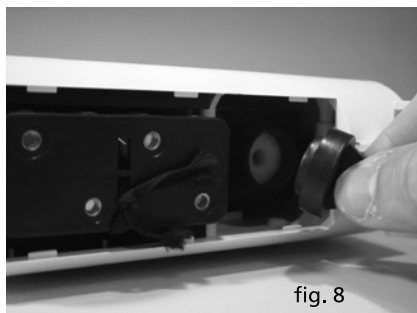

 **WARNING - Use only 3A original filters.**

 **WARNING - Do not use the unit without a filter.**

UNIT TECHNICAL FEATURES

Nominal voltage: INPUT 100-240 VAC 50/60 Hz -
0.6-0.3 A - OUTPUT 12VDC 1,67 A

Intermittent use: 30min I / 30min O

MDD 93/42/EEC - Class of risk: IIa

 Class II unit

 Type BF unit

 **Warning!** Check the user instruction

I/O Switch ON/Switch OFF

 Alternating current (ac)

 Continuous current (dc)

 Do not use the unit while bathing or showering

 **Important information for correct disposal of the product in accordance with EC directive 2002/96/EC**
at the end of its life, the product must not be disposed of as urban waste. It must be taken to a special local authority differentiated waste collection centre or to a dealer providing this service

Dimensions: 140x128x56 mm

Weight: 600gr. - 850gr. with battery

Max pressure: 200 kPa (2.0 bar)

Max free air flow: 11 l/min

Noise level: 49 dBA

Neb rate: 0.45ml/min (with 4ml NaCl 0.9%)

Autonomy with rechargeable battery: > 40 min. with 1500mAh battery capacity

Operating conditions:

- temperature: min. 10°C; máx 40°C

- air humidity: min. 10%; máx 95%

Storage conditions:

- temperature: min. -25°C; máx 70°C

- air humidity: min. 10%; máx 95%

Performances EN13544-1: See the extra paper instruction of Nebulizer FASTERJET

Operating pressure: 70kPa (0.7bar)

Operating air flow: 5.3 l/min

MMAD: 3.15 µm

GSD: 2.88

Aerosol Output: 293 µl

Output Rate: 130 µl/min

WARRANTY CERTIFICATE

VALIDITY 24 MONTHS from date of purchase

Date of purchase

Dealer(Stamp and signature)

This warranty certificate is valid only if returned to your dealer along with Receipt and Faulty Unit.
Warranty does not cover damages caused by misuse, crashes or lack of attention.

DESCRIZIONE GUASTO/ FAULT DESCRIPTION

WHEN SUBMITTING A WARRANTY CLAIM, IN OBSERVANCE OF THE ABOVE CONDITIONS, SEND THE UNIT TOGETHER WITH THE CERTIFICATE BELOW AND PROOF OF PURCHASE TO: 3A HEALTH CARE SRL - VIA MARZIALE CERUTTI, 90/F - 25017 LONATO (BS) - ITALY.



Manufacturer:
3A HEALTH CARE SRL
Via M. Cerutti, 90/F - 25017 Lonato (BS) - Italy
www.3-a.it